

BB-301 - КРАНОВ ВЪЗЕЛ 1-КМ 27+659 / BLOCK VALVE STATION 1-KP 27+659

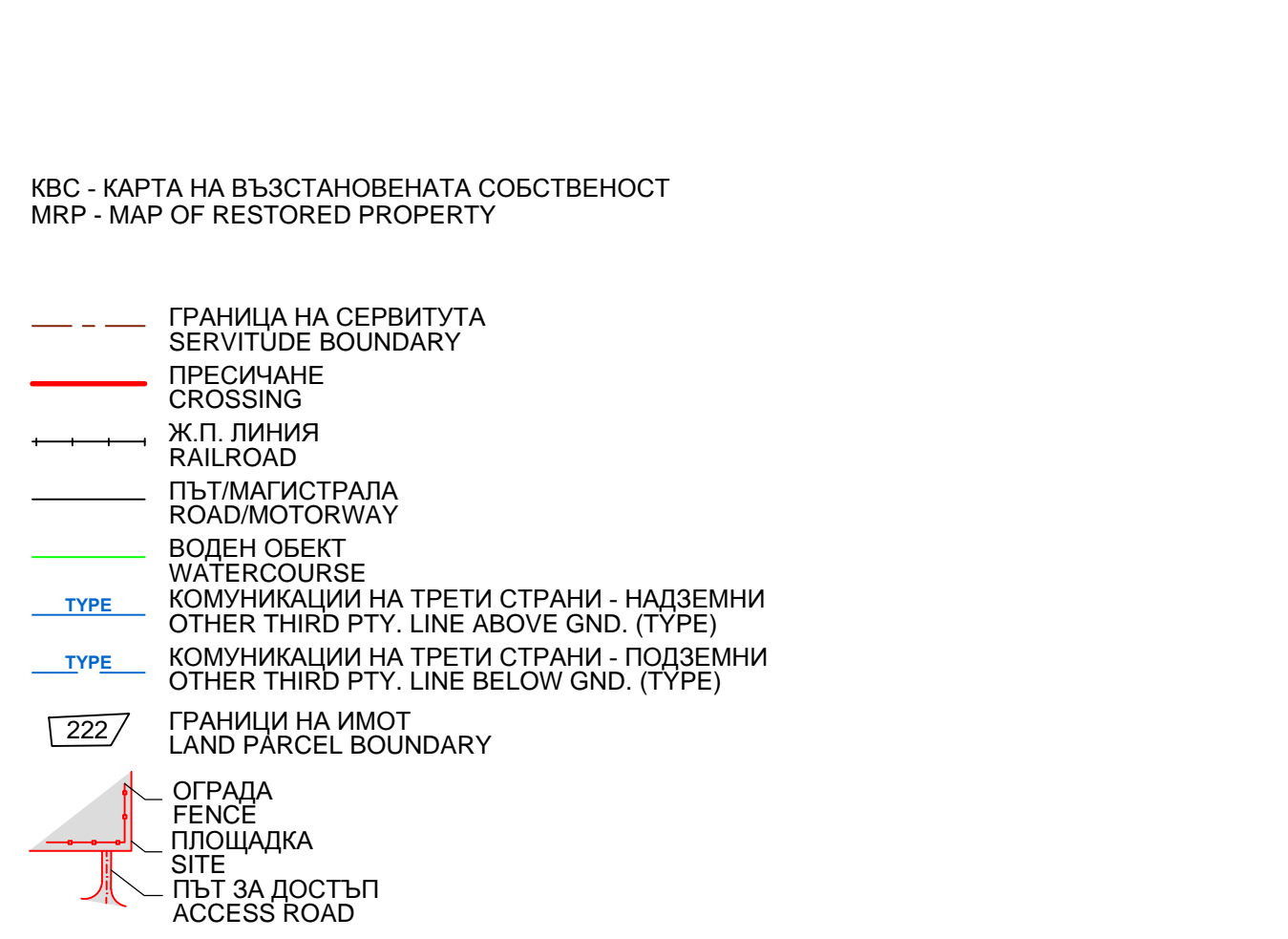
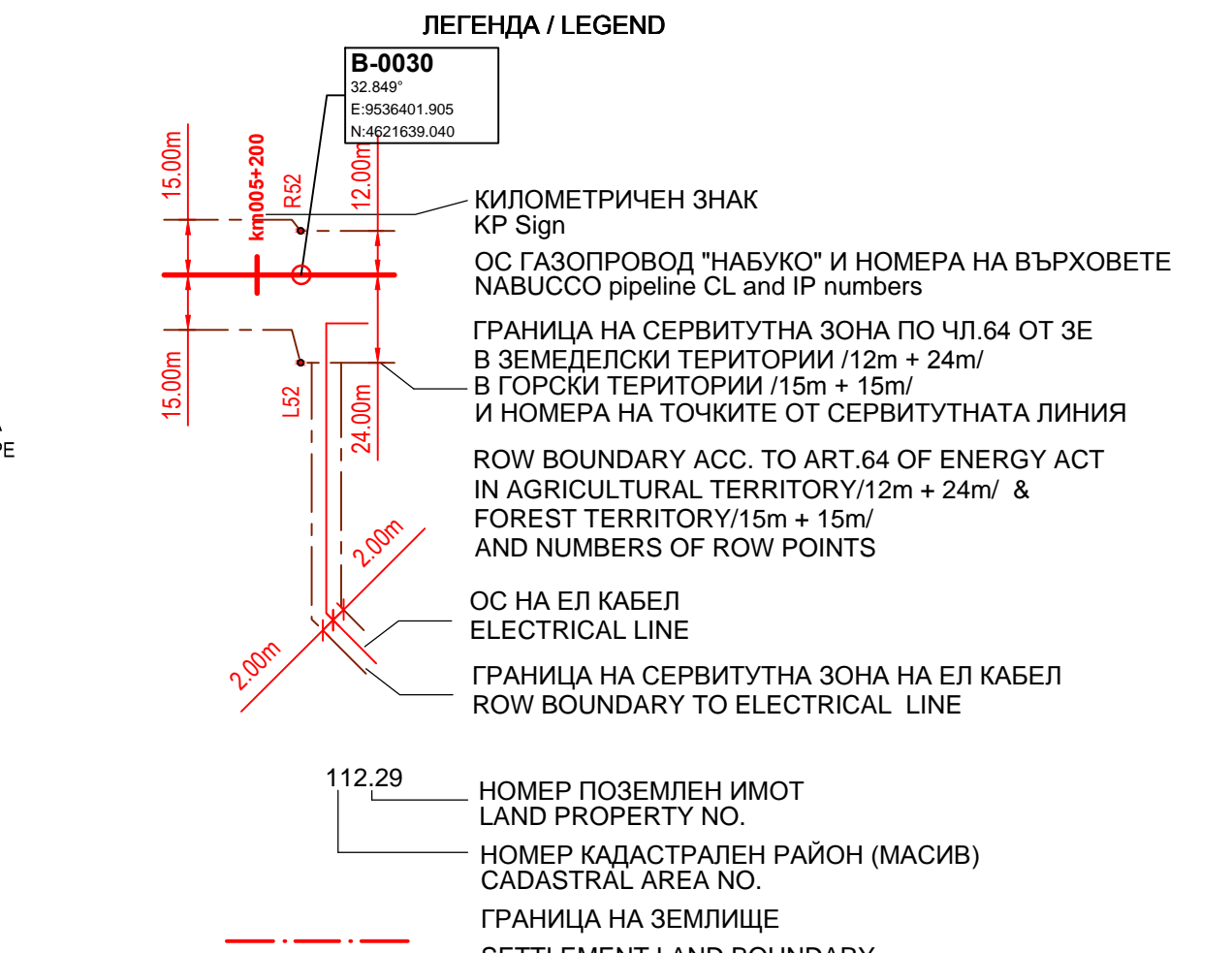
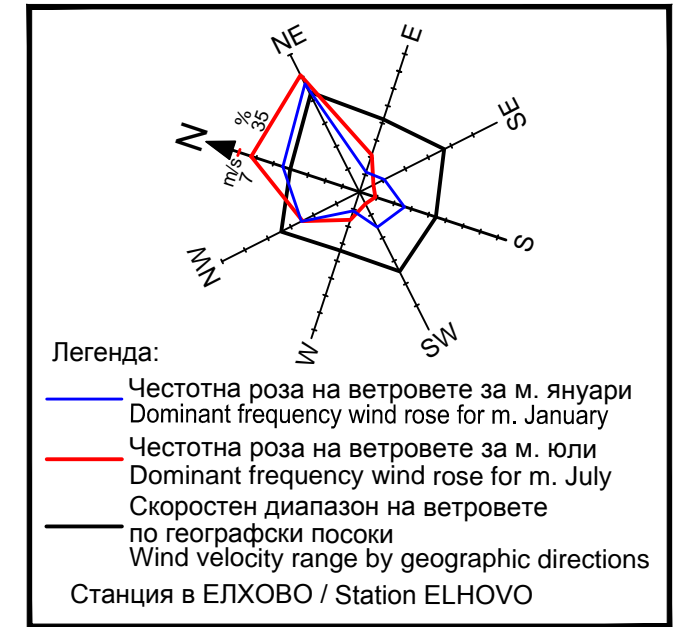
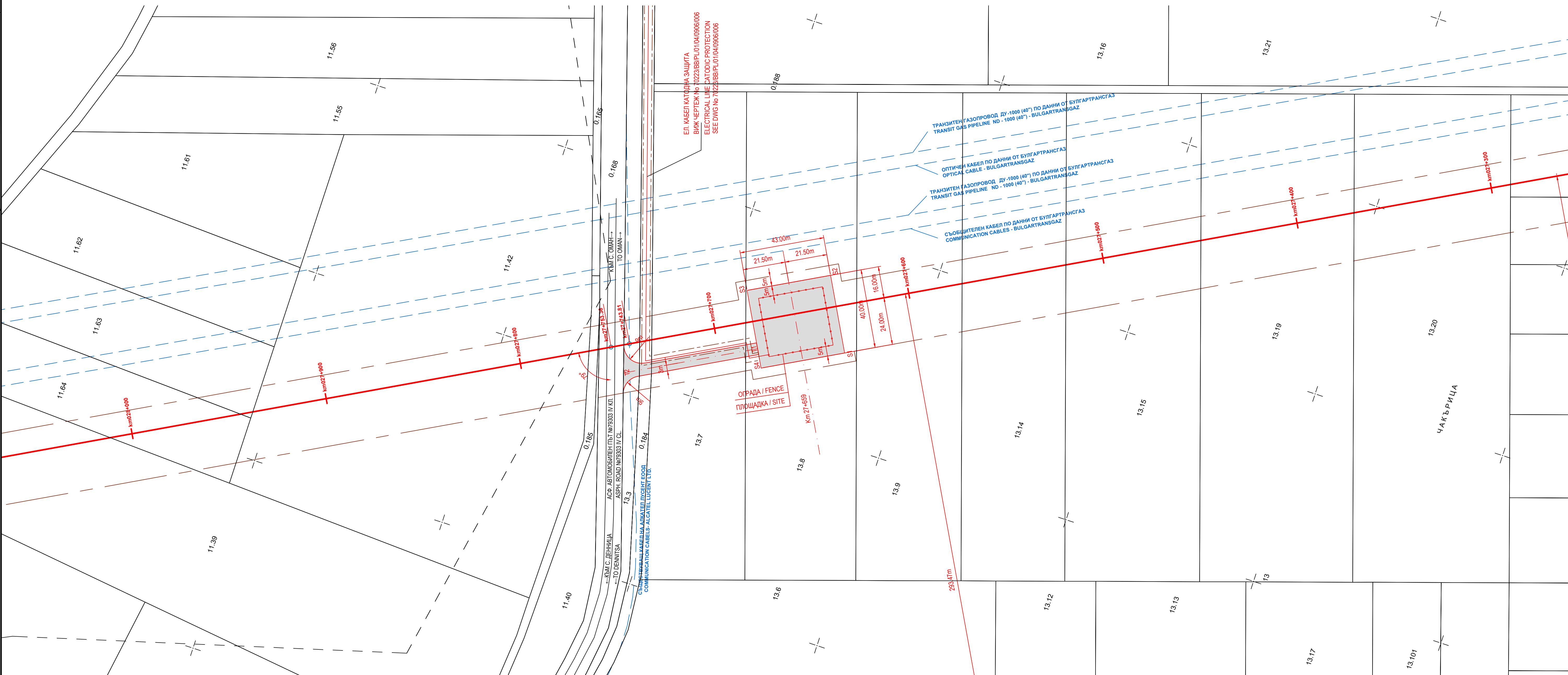

Table with 2 columns: 'КООРДИНАТИ НА ГРАНИЦАТА НА ПЛОЩАДКАТА' and 'КООРДИНАТИ НА ОСТА НА ПОДХОДЕН ПЪТ'. It lists coordinates for points S1-S4 and T1-T2, along with area calculations for the site and access road.

ЗАБЕЛЕЖКИ / NOTES: - ГРАНИЦАТА НА ЗОНАТА С РЕЖИМ НА ПРЕВАНТИВНА УСТРОЙСТВЕНА ЗАЩИТА ПО ЧЛ.10 ОТ ЗУТ Е 2 x 200 м СИМЕТРИЧНО ОТ ОСТА НА ГАЗОПРОВОДА...

Table for 'Approved by / Съгласували:' with columns for Discipline Code, Name / Имя, Signature / Подпис, and Date / Дата. It includes a signature and date for client review.

Client information: NABUCCO GAS PIPELINE PROJECT. Includes logos for Nabucco Gas Pipeline International GmbH and CHIMCOMPLEX ENGINEERING COMPANY. Project title: BLOCK VALVE STATION 1 /BB 301/ KP 27+659.

Project details table including Project Name (ПОДРОБЕН УСТРОЙСТВЕН ПЛАН (ПУП) - ПАРЦЕЛАРЕН ПЛАН (ПП)), Phase (ОКОНЧАТЕЛЕН ПРОЕКТ), and a revision table with columns for No., Date, and Description.